

## RADIAL LEADS TAPING SPECIFICATIONS:

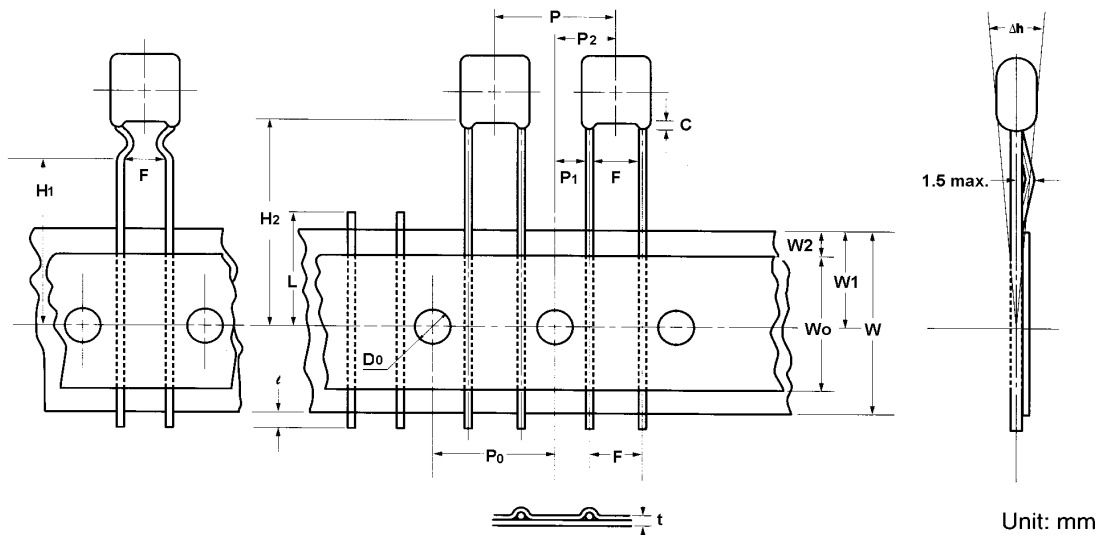

ITEM	SYMBOL	DIMENSIONS	TOLERANCE
Pitch of component	P	12.7	± 1.0
Feed hole Pitch	P <sub>0</sub>	12.7	± 0.3
Feed hole center to lead	P <sub>1</sub>	3.85	± 0.7
Hole center to component center	P <sub>2</sub>	6.35	± 1.3
Lead-to-lead distance	F	5.0	± 0.8
Component alignment, F-R	Δh	0	± 2.0
Tape width	W	18.0	+ 1.0 – 0.5
Hold-down tape width	W <sub>0</sub>	11.0	min.
Hole position	W <sub>1</sub>	9.0	+ 0.75 – 0.5
Hold-down tape position	W <sub>2</sub>	3.0	max.
Height of Component from tape center	for Straight Lead Type	H <sub>1</sub>	± 0.75
	for Kinked Lead Type	H <sub>2</sub>	± 0.5
Lead crimp height	H <sub>0</sub>	16.0	± 0.5
Lead-wire protrusion	ℓ	2.0	max.
Feed hole diameter	D <sub>0</sub>	4.0	± 0.3
Total tape thickness	t	0.7	± 0.2
Length of snipped lead	L	11.0	max.

### REEL PACKAGE

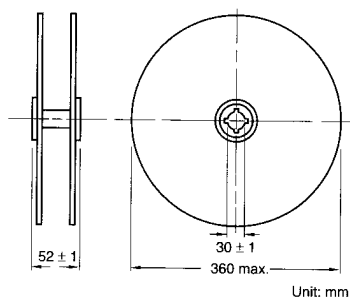

### AMMO BOX PACKAGE

